

FEATURES

- Low glare solution (<UGR 19)



SPRINGS

Standard with CS spring (concrete/gyproc). Also available as above with WS spring (gyproc/metal).

COLOURS

Available colours:



Matt white RAL 9016 (XX=MW)
Matt black RAL 9005 (XX=BL)



Size Linea 50 compared to Linea 75



Backside view Linea 50 and Linea 75

Linea 50
Fixed

SPECIFICATIONS

Beam angle	40°/60°
Fixture material	Housing: Die cast aluminium / Lens: Polycarbonate
Environment	Indoor
CCT	2700K / 3000K / 4000K
CRI	93
IK rate	IK02
IP rate	IP20
Operating temperature	-20°C / +45°C
Safety marks	EN60598 / EN62031 / EN62471
EMC compliance	EN55015
Colour consistency	MacAdam step 3
Warranty	7 years* (within the European Union and the countries of the Free Trade Association for products delivered after 1 May 2015)
Energy class	These products contain a light source of energy efficiency class F (2700K/3000K) / E (4000K)

This luminaire contains built-in LED lamps. There are no exchangeable parts inside the luminaire. EU 874/2012

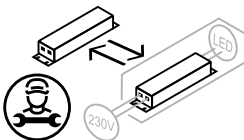

LINEA 50 VARIATIONS

Linea 50 LV	220-240V	incl. power supply	page 3
Linea 50 LVC	700mA	to be connected to a central power supply	page 4

DIMENSIONS

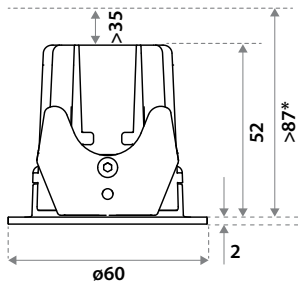

The lifetime expectation is measured in a recessed ceiling with normal air ventilation (Ta 25°C). When built directly in the concrete material, it is possible to keep the standard expected lifetime. If the airflow is less than 5 mm (for instance, built in a very small plastic box or covered with insulation material), it is advisable to set the input current of the driver to 350 mA to keep the same lifetime.

*This distance is necessary because of the height of the connection box (80 mm). For purely heat reasons, just 5 mm is sufficient.

CUT-OUT



Using CS springs: Ø 50 mm.
Thickness ceiling 5-87 mm &
recess depth 87 mm.



Using WS springs. Ø 50 mm.
Thickness ceiling 1-20 mm &
recess depth 87 mm.

LINEA 50 (dimmable - incl. individual power supply)

CRI93 / 220-240V

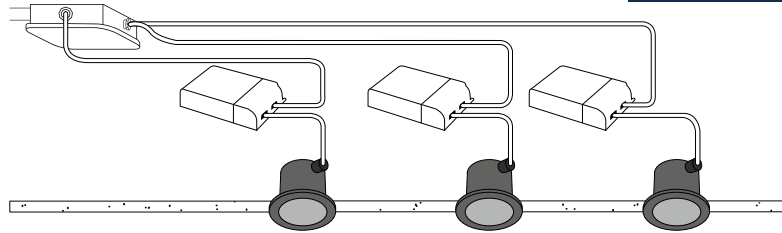

ITEM SPECIFICATIONS (PART A)

Description	Item code CS	WS	Input	W	Lm	Lm/W	CRI (typ.)	UGR	Pf	Ripple	Inrush current	B-16A Fuse
Linea 50 LV 2700K 625Lm CRI93 40° No dim	NA3R03XX5Y02	NA3R03XX9R02	220-240V	9,4	625	66	93	17,3	>0,95	<3%	8,5A 16μS	58 pcs
Linea 50 LV 3000K 650Lm CRI93 40° No dim	NA3S03XX5Y02	NA3S03XX9R02	220-240V	9,4	650	69	93	17,5	>0,95	<3%	8,5A 16μS	58 pcs
Linea 50 LV 4000K 675Lm CRI93 40° No dim	NA3T03XX5Y02	NA3T03XX9R02	220-240V	9,4	675	72	93	17,6	>0,95	<3%	8,5A 16μS	58 pcs
Linea 50 LV 2700K 625Lm CRI93 40° Triac	NA3R03XX5V02	NA3R03XX9N02	220-240V	9,4	625	66	93	17,3	0,96	<20%	2A 50μS	50 pcs
Linea 50 LV 3000K 650Lm CRI93 40° Triac	NA3S03XX5V02	NA3S03XX9N02	220-240V	9,4	650	69	93	17,5	0,96	<20%	2A 50μS	50 pcs
Linea 50 LV 4000K 675Lm CRI93 40° Triac	NA3T03XX5V02	NA3T03XX9N02	220-240V	9,4	675	72	93	17,6	0,96	<20%	2A 50μS	50 pcs
Linea 50 LV 2700K 625Lm CRI93 40° Dali	NA3R03XX5W02	NA3R03XX9P02	220-240V	9,4	625	66	93	17,3	>0,94	<3%	7,5A 16μS	66 pcs
Linea 50 LV 3000K 650Lm CRI93 40° Dali	NA3S03XX5W02	NA3S03XX9P02	220-240V	9,4	650	69	93	17,5	>0,94	<3%	7,5A 16μS	66 pcs
Linea 50 LV 4000K 675Lm CRI93 40° Dali	NA3T03XX5W02	NA3T03XX9P02	220-240V	9,4	675	72	93	17,6	>0,94	<3%	7,5A 16μS	66 pcs
Linea 50 LV 2700K 625Lm CRI93 60° No dim	NA3R03XX4L02	NA3R03XX9L02	220-240V	9,4	625	66	93	21,2	>0,95	<3%	8,5A 16μS	58 pcs
Linea 50 LV 3000K 650Lm CRI93 60° No dim	NA3S03XX4L02	NA3S03XX9L02	220-240V	9,4	650	69	93	21,4	>0,95	<3%	8,5A 16μS	58 pcs
Linea 50 LV 4000K 675Lm CRI93 60° No dim	NA3T03XX4L02	NA3T03XX9L02	220-240V	9,4	675	72	93	21,5	>0,95	<3%	8,5A 16μS	58 pcs
Linea 50 LV 2700K 625Lm CRI93 60° Triac	NA3R03XX4D02	NA3R03XX9D02	220-240V	9,4	625	66	93	21,2	0,96	<20%	2A 50μS	50 pcs
Linea 50 LV 3000K 650Lm CRI93 60° Triac	NA3S03XX4D02	NA3S03XX9D02	220-240V	9,4	650	69	93	21,4	0,96	<20%	2A 50μS	50 pcs
Linea 50 LV 4000K 675Lm CRI93 60° Triac	NA3T03XX4D02	NA3T03XX9D02	220-240V	9,4	675	72	93	21,5	0,96	<20%	2A 50μS	50 pcs
Linea 50 LV 2700K 625Lm CRI93 60° Dali	NA3R03XX4E02	NA3R03XX9E02	220-240V	9,4	625	66	93	21,2	>0,94	<3%	7,5A 16μS	66 pcs
Linea 50 LV 3000K 650Lm CRI93 60° Dali	NA3S03XX4E02	NA3S03XX9E02	220-240V	9,4	650	69	93	21,4	>0,94	<3%	7,5A 16μS	66 pcs
Linea 50 LV 4000K 675Lm CRI93 60° Dali	NA3T03XX4E02	NA3T03XX9E02	220-240V	9,4	675	72	93	21,5	>0,94	<3%	7,5A 16μS	66 pcs

ITEM SPECIFICATIONS (PART B)

Description	Safety class	Energy class	Weight	Dimensions single carton	Quantity per carton	Expected Lifetime			Reported Lifetime*		
						L70B10	L80B10	L90B10	L70B10	L80B10	L90B10
Linea 50 LV 2700K CRI93	II	F	108 gr	105x105x105 mm	42 pcs	177.000 hrs	113.000 hrs	51.000 hrs	>102.000 hrs	>102.000 hrs	51.000 hrs
Linea 50 LV 3000K CRI93	II	F	108 gr	105x105x105 mm	42 pcs	177.000 hrs	113.000 hrs	51.000 hrs	>102.000 hrs	>102.000 hrs	51.000 hrs
Linea 50 LV 4000K CRI93	II	E	108 gr	105x105x105 mm	42 pcs	177.000 hrs	113.000 hrs	51.000 hrs	>102.000 hrs	>102.000 hrs	51.000 hrs

All values are measured at 230V (+/- 7%). *Based on 17.000hrs of LM80 testing at 700mA and a Tc85 °C.

CHOOSE YOUR LV LUMEN OUTPUT

	mA	Vf	W	Lumen Output			Lumen / Watt			Driver types		
				2700K	3000K	4000K	2700K	3000K	4000K	KGP No dim	TCI Triac	KGP Dali
Special request	350	11,1	4,5	350	375	400	78	84	90	CC7W100-700	127040	CC20W100-800
Special request	500	11,4	6,6	500	525	550	76	80	84	CC7W100-700	127042	CC20W100-800
Standard	700	11,7	9,4	625	650	675	66	69	72	CC36W150-900	127046	CC20W100-800

INCL. PSU

PSU KGP 36W No dim NFC 163x30x21 mm
PSU TCI 127046 Triac dim 102x38x21 mm
PSU KGP 20W Dali 110x40x21 mm



Cable
150 mm

LINEA 50 (dimmable - excl. central power supply)

CRI93 / 500 mA

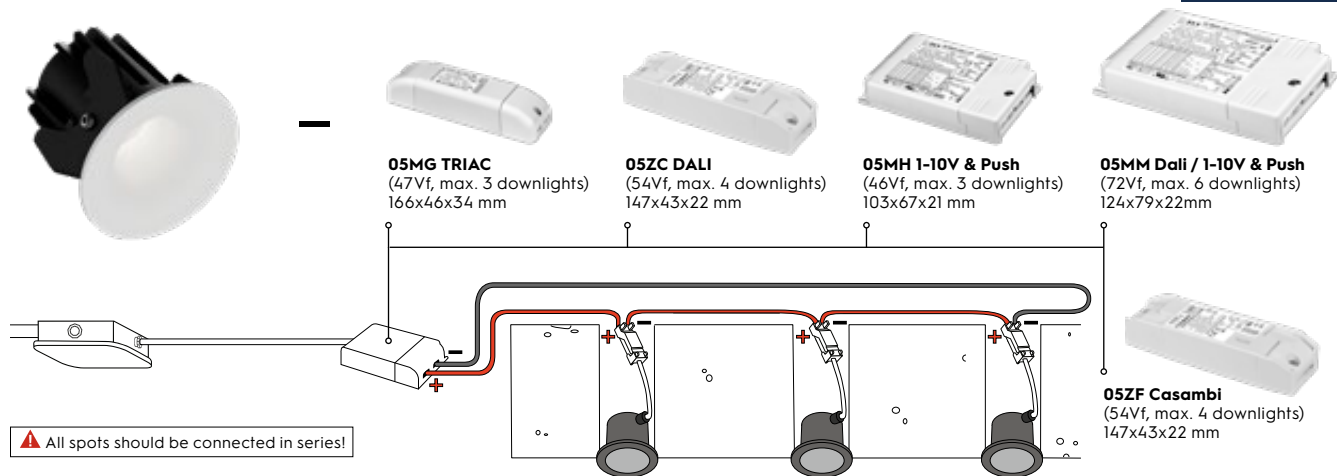

ITEM SPECIFICATIONS (PART A)

Description	Item code CS	Item code WS	Input	Vf	W	Lm	Lm/W	CRI (typ.)	UGR	Pf	Ripple	Inrush current	B-16A Fuse
Linea 50 LVC 700mA 40° 625 Lm 2700K	NA3R03XX5YE2	NA3R03XX9RE2	700mA	11.7	8,2	625	76	93	17.2	x	x	x	x
Linea 50 LVC 700mA 40° 650 Lm 3000K	NA3S03XX5YE2	NA3S03XX9RE2	700mA	11.7	8,2	650	79	93	17.3	x	x	x	x
Linea 50 LVC 700mA 40° 675 Lm 4000K	NA3T03XX5YE2	NA3T03XX9RE2	700mA	11.7	8,2	675	82	93	17.4	x	x	x	x
Linea 50 LVC 700mA 60° 625 Lm 2700K	NA3R03XX4LE2	NA3R03XX9LE2	700mA	11.7	8,2	625	76	93	21.1	x	x	x	x
Linea 50 LVC 700mA 60° 650 Lm 3000K	NA3S03XX4LE2	NA3S03XX9LE2	700mA	11.7	8,2	650	79	93	21.2	x	x	x	x
Linea 50 LVC 700mA 60° 675 Lm 4000K	NA3T03XX4LE2	NA3T03XX9LE2	700mA	11.7	8,2	675	82	93	21.3	x	x	x	x

ITEM SPECIFICATIONS (PART B)

Description	Safety class	Energy class	Weight	Dimensions single carton	Quantity per carton	Expected Lifetime			Reported Lifetime*		
						L70B10	L80B10	L90B10	L70B10	L80B10	L90B10
Linea 50 LVC 700mA 2700K CRI93	III	F	108 gr	105x105x61 mm	42 pcs	177.000 hrs	113.000 hrs	51.000 hrs	>102.000 hrs	>102.000 hrs	51.000 hrs
Linea 50 LVC 700mA 3000K CRI93	III	F	108 gr	105x105x61 mm	42 pcs	177.000 hrs	113.000 hrs	51.000 hrs	>102.000 hrs	>102.000 hrs	51.000 hrs
Linea 50 LVC 700mA 4000K CRI93	III	E	108 gr	105x105x61 mm	42 pcs	177.000 hrs	113.000 hrs	51.000 hrs	>102.000 hrs	>102.000 hrs	51.000 hrs

ITEM SPECIFICATIONS (PSU)

Description	Item code	Input	Watt	Current	Efficiency	Pf	Ripple	Weight	Inrush current	B-16A Fuse
PSU 32W 700mA Triac	05MG03MLMF00	220-240V	32W (46Vf)	700mA	85%	0.97	<3%	138 gr	5A 50µS	50 pcs
PSU 38W 700mA Dali	05ZC03MLMF00	220-240V	38W (54Vf)	700mA	89%	0.95	<3%	139 gr	5A 50µS	50 pcs
PSU 32W 700mA 1-10V & Push	05MH03MLMF00	220-240V	32W (46Vf)	700mA	88%	0.95	<3%	138 gr	5A 50µS	50 pcs
PSU 36W 700mA Casambi	05ZF03MLMF00	220-240V	36W (51Vf)	700mA	89%	0.95	<3%	139 gr	5A 50µS	50 pcs
PSU 50W 700mA Dali / 1-10V & Push	05MM03MLMF00	220-240V	50W (72Vf)	700mA	89%	0.95	<3%	218 gr	10A 200µS	30 pcs

All values are measured at 230V (+/- 7%). *Based on 17.000hrs of LM80 testing at 700mA and a Tc85 °C.

INCLUDING CONNECTION BOX

For installation to a central power supply.

